

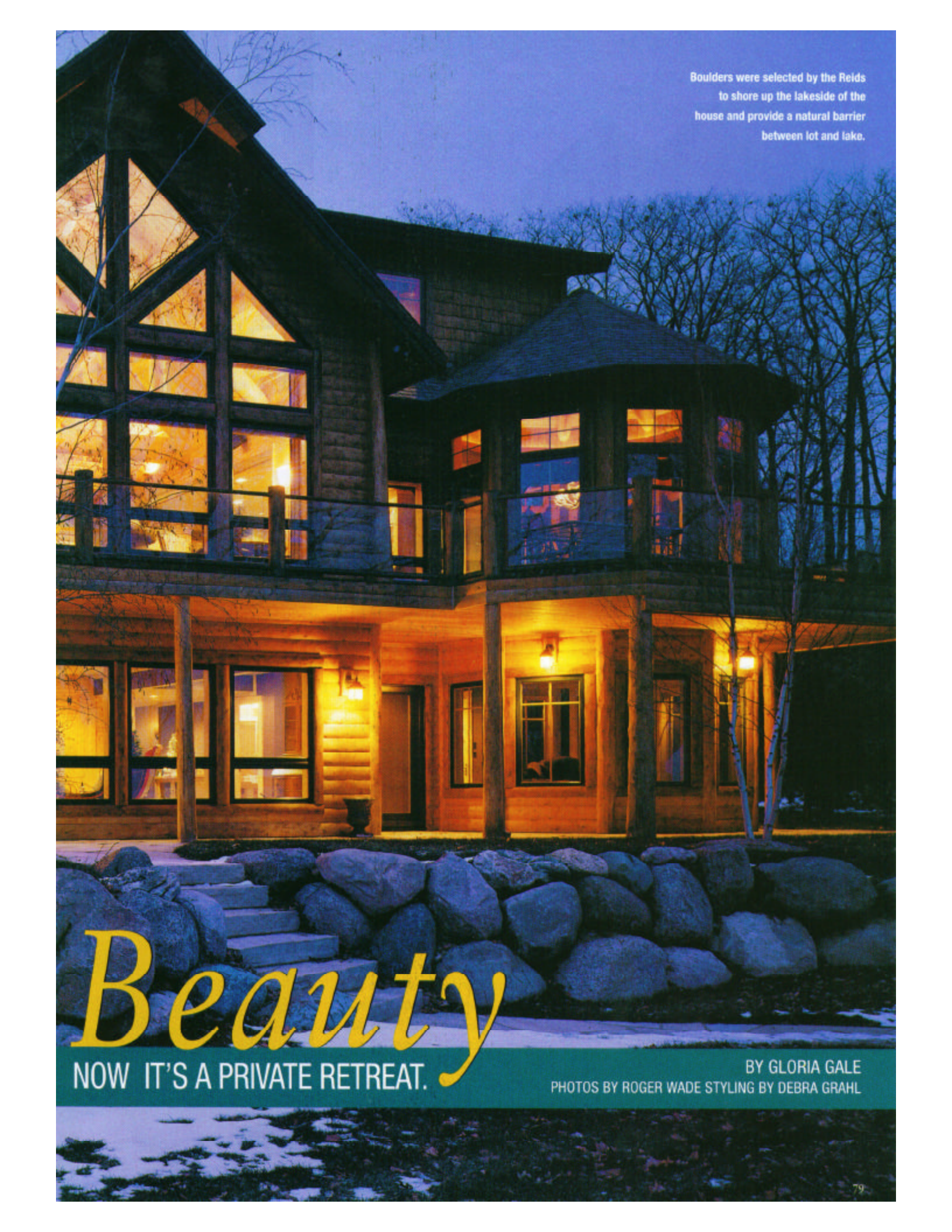

A Lakeshore

A FAMILY LOOKS FORWARD TO MOVING IN FULL TIME, BUT FOR



Boulders were selected by the Reids to shore up the lakeside of the house and provide a natural barrier between lot and lake.

Beauty

NOW IT'S A PRIVATE RETREAT.

BY GLORIA GALE
PHOTOS BY ROGER WADE STYLING BY DEBRA GRAHL



ABOVE: Natural stone pillars customize the front of the house as does the graceful arch and covered porch. **RIGHT:** Two-story windows in the great room offer expansive outdoor views of Burt Lake. This is the gathering place for the Reid family on traditional holidays such as Christmas.

For those who have spent time in northern Michigan's inland waterways, the area has the uncanny ability to evoke vivid memories of carefree summers and cozy winters. Enamored by the region's natural allure, Carl and Kim Reid wanted to ensure the same memories for their family. Ultimately, they decided to build a second home on their lakeside property.

Previously, Carl had owned a 1970s-style trilevel home on a secluded lot fronting Burt Lake. "I had owned a house for 10 years that was sorely in need of an update. Because this part of upper Michigan is such a recreational spot with ski mountains nearby, dense woods, and this beautiful lake, when Kim and I got married last year, we decided we wanted a home that reflected the rustic charm of the area," says Carl. "We considered various styles of homes, often while boating on the lake. This gave us the opportunity to idle by various homes before settling on one made of logs," adds Kim.

Early in 1999, Carl happened to be running late for a golf date with his buddies and decided to take an alternate route on US 131 near Petoskey. "This route proved to be a stroke of good luck since it took me by the Town & Country Cedar Homes model. I had looked at other log homes before, but they didn't quite feel right," he said.

After a hard day on the links, he rushed home to tell Kim that he saw a log home that he knew she would love. "My reaction was exactly as Carl anticipated—I simply fell in love with the idea," says Kim.

The Reids, whose primary residence in Brighton, Mich., is 250 miles south of the lake, made arrangements to visit the Town & Country facility in Petoskey. According to Carl and Kim, the minute they stepped into the model they immediately knew they were on the right track. "It smelled good, there were gorgeous views and lovely appointments throughout the home. Everything clicked," agreed the couple.







"I remember discussing the merits of a log home with Kim, noting that this company builds just the way we hoped, light and airy. They featured homes that had a combination of white cedar logs and tongue-and-groove with a refined yet rustic feel ... I guess you could say this was a modern house with a bit of country," says Carl. The couple agreed that their future home would fit in beautifully on their 2.5-acre property.

Doug Boor, design manager with Town &

Country, offered Kim and Carl lodging in one of the log homes. "The Reids' immediate reaction was very positive. In fact, they really liked the look of Town & Country's Preserve model," says Boor.

Basically, the Reids were on a fast track. Over the next few months they had a half-dozen meetings with Town & Country to refine the plans. Their efforts yielded a 6,000-square-foot home featuring a

lower level walkout, a breezeway connecting to a separate garage, and four bedrooms plus a bonus room. "There were also a couple of other changes we made, like adding the elevator and a sauna," says Carl.

"At that point, Town & Country recommended Joe Blasius as our builder. He turned out to be a great guy whom we trusted implicitly," says Kim.

The foundation was poured on the first of September 2000. Prior to that, the lot had



been cleared of the former house and the site graded for better drainage. "Since we lived nearly four hours away, my folks, who live closer to the lake, were there to inform us of the crew's progress. To satisfy my curiosity and generally keep on top of things, I eventually ended up going every week and Carl about every three weeks," says Kim.

Blasius's crew operated smoothly as the house was framed over nine months. "The only constraint to speak of was the lot size,



ABOVE: An octagonal dining room sits in a turret situated between the great room and kitchen. Adding a slight softening of burgundy drapes helps customize the French country décor. **LEFT:** Kim wanted pine cabinets with no soffit above. The cooktop rests in a center island.

which isn't very deep or wide—just 100 feet wide and 180 feet in depth. It was a tight fit with a 75-foot set back from the lake. "The guys had to continuously move their supplies," recalled Carl.

As the house progressed over the next year and a half, it was apparent that the couple's planning would pay off handsomely. Situated on a secluded private drive, the house has a southwest orientation. The 20-foot-high elevation above the water boasts expansive views of the lake. "The entire back of the house has glass walls that are basically unobstructed. We even built a railing with glass dividers on the entire back deck so there wouldn't be any obstacles," says Carl.

A covered porch leads to the entry, where a graceful arch leads into the main-level foyer. Inside, slate floors lead the way to rooms that blend seamlessly with one another.

One of the first things to notice is the flood of light spilling in from substantial windows in the great room. This room holds two mas-

sive king post trusses, which support the 25-foot vault of the ceiling. All wood here and throughout the house is stained in a light honey color.

Because the Reids wanted an open, airy feeling, each room melds into another. It's only a step from the great room to the adjacent dining room that reposes in an octagonal-shaped turret.

Entertaining is easily accomplished via the olive green and pine-accented kitchen. "When we're not eating in the dining room, we're in the kitchen. There is a solid surface breakfast bar, plenty of granite countertops, and cabinets with glass fronts. This room gets plenty of use," says Kim.

The master bedroom/bath, laundry, library, and mudroom complete the main level. All these rooms are within easy access of one another. Admits Kim, "I think if there's anything we would have done differently, I would have made the kitchen larger because we have



a big blended family and I love to cook.”

An elevator between the lower and main level provides a convenience that the Reids agree is a necessity. Descending to the lower level either by stairs or the elevator, a guest suite and recreation room await family members, who tend to arrive frequently. “There is a small room tucked just underneath the dining room. One of the framers on Joe’s crew named it the ‘Lighthouse room’ owing to its

cozy, octagonal shape. It’s a perfect hideaway to read or just view the lake,” says Kim.

Four natural fieldstone fireplaces—two gas-heated and two wood-burning—are located strategically throughout the house. The winters are cold and deliver lots of snow, but, says Carl, “We’ve found that propane works just fine for our heating. In addition to the forced-air furnace, there’s

radiant heat underneath the downstairs flooring.”

“We do have a considerable amount of sunlight pouring in from windows across the back of the house,” says Kim. As a result, the Reids installed air conditioning along with ceiling fans in various rooms to keep temperatures comfortable in the summertime.

This home is filled with color. From shades of deep olive to burgundy, the home conveys



tasteful elegance. "Although I designed the couch in the great room," says Kim, "much of the décor was suggested by Meg Redli of Interiors Inc., a design firm Town & Country recommended. We loved what she proposed."

"Our entire family, including Carl's three sons, are thrilled with the custom touches. For example, on the second floor there's a bedroom with a moose motif and another bed

Continued on page 113

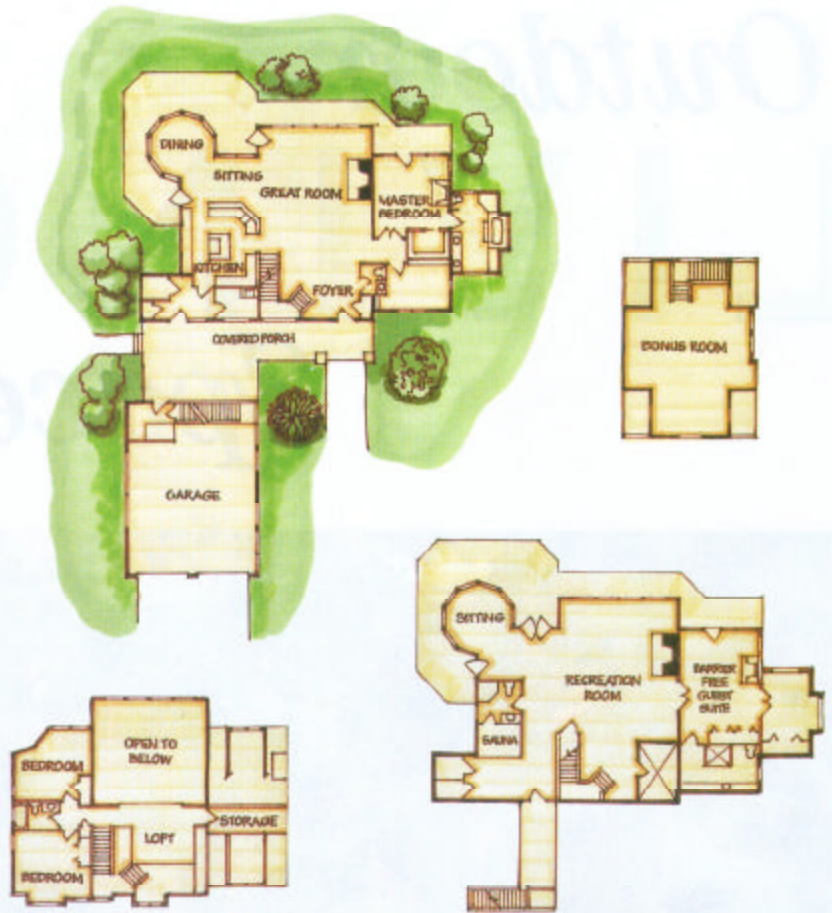

ABOVE: Even the master bathroom has its share of natural light. Neutral-colored tile enhances the space and complements the rust-colored walls. **OPPOSITE:** The Reids wanted windows in nearly every room to maximize the view toward the lake. They also added a considerable amount of log touches including log mantels, beams, trusses, and various hand-carved furnishings.

LAKESHORE BEAUTY

Continued from page 85

room with a grizzly bear hand-carved bed. In the guest suite downstairs you'll find a sleigh bed, and our own bed on the main level is made from hand-carved California Redwood," says Kim.

Carl adds, "With an unattached garage, I thought it would be nice to have a concrete tunnel poured to connect into the house. It turned out to be advantageous and it's quite useful, especially in the winter."

The Reids made sure their home reflects their casual lifestyle. They used slate on the floors for durability in the foyer, half-bath, kitchen, laundry, and mudroom while the rest of the house is carpeted in a tightly woven neutral blend. "To avoid having the house become too dark, we used about half drywall and half log. Where drywall is used, a distinctive mix of subtle olive and dusty deep greens dominate the color scheme—we think the mix is perfect," says Kim.

One of the best times of the year is at Christmas. "I start decorating at Halloween and don't take down the decorations until the middle of January," Kim muses. "Christmas is a time when we love to go all out. We have several trees, and the house is packed with lights and garland. Both Carl and I collect Santas so we have them displayed. With all the trees, lights, wreaths, and hopefully lots of snow, we have a full schedule entertaining family and friends. We are very, very popular," Kim says with a laugh.

In a year or so, the couple's youngest child will go off to college. "I think at that point we will consider selling our home in Brighton and making this our primary residence." It won't come a minute too soon since Carl and Kim routinely visit their second home at least once a month. "We are looking forward to living here full time," says Kim.

In the meantime, the kids think this place is unbelievable. While Carl and Kim call this their "cabin," the kids scoff, "This isn't a 'cabin,'" they protest with a laugh, "it's a lodge!" Whatever you call it, this home is definitely where everyone wants to be. ❁

LOG HOME MANUFACTURER: Town & Country Cedar Homes, Petoskey, Michigan; **BUILDER:** Joe Blasius, Lakeshore Contracting, Harbor Springs, Michigan; **INTERIOR DESIGN:** Meg Redli, ASID-Interiors Incorporated, Petoskey, Michigan.