



Northville Lodge

Incredible. That's how you'll describe the experience having spent only a few luxurious minutes in this breathtaking home! The organic finishes of slate, stone, Northern White Cedar, Alder, Cherry, brick, cast iron, and bronze make this home a masterpiece! In addition to the standard amenities and the magnificent finishes, this incredible design features curved staircases, a butler's pantry, formal study, two fireplaces, and two custom radial bay elements on the main level. A mouth-watering lower level completes the experience, offering a home theater, billiard room, gift-wrapping room, fully furnished kitchen/wet bar, and family living area. Who could ask for anything more?

DESIGN ■ PRODUCE ■ BUILD

800.968.3178

www.cedarhomes.com

Northville Lodge

Total Living Area As Shown: 5,051 Sq. Ft.

**4 Bedrooms, 4 Full Baths, 2 Half Baths,
Formal & Informal Dining, Library,
Bonus Room**

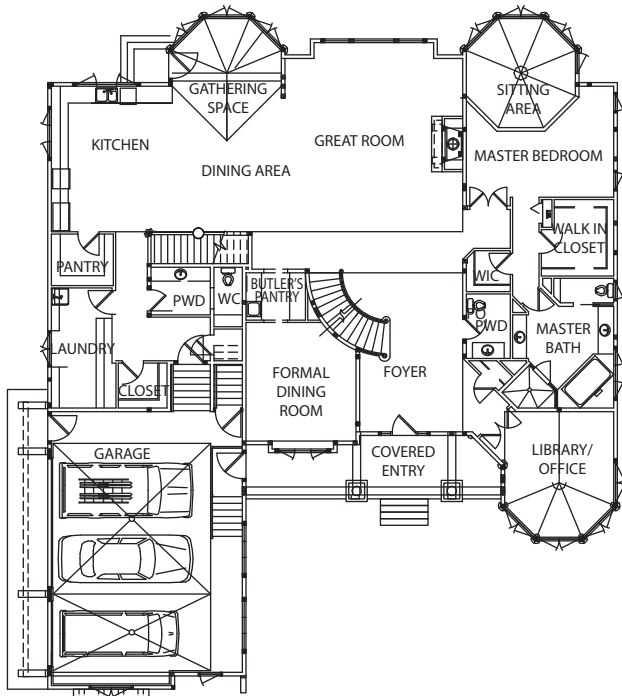

FIRST FLOOR: 3,635 SQ. FT.

SECOND FLOOR: 1,416 SQ. FT.

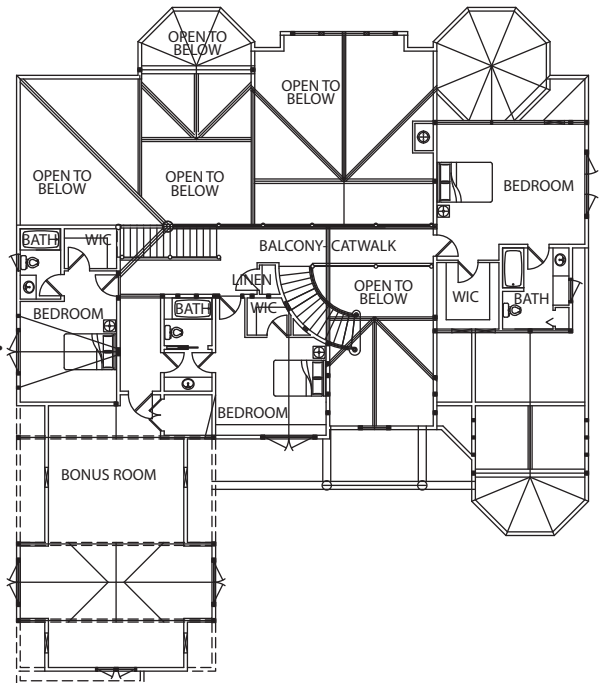

**Town & Country Cedar Homes:
No Comparison. No Compromise.**

*All Town & Country Cedar Homes
floor plans may be customized to allow for less or
additional living space, as well as created in
alternative architectural styles or finishes.*

OPTIONAL LOWER LEVEL: 3,086 SQ. FT. NOT SHOWN